



Series 1735

Soft Laminate and Fine Metal Edge End Mill



Designed for Ultra-fine Edge Finish

When flawless edges are required

Great for soft PCB laminate materials and metals

Capable of surface milling and plunging

Smooth edges and cleanly cut fibers

Does not require use of entry material

Series 1735

Soft Laminate and Fine Metal Edge End Mill

Series 1735 End Mills designed to provide an ultra-fine edge finish on soft PCB laminate materials and metals that require flawless edges. End Style allows surface milling and plunging.

Flex products, Aramid reinforced materials, PTFE, most soft materials, and gold fingers are prime examples of the challenges posed to PCB Fabrication Departments worldwide. In some cases, parameters can be adjusted with standard tools to address the rough edges, raised burrs, and/or fibers. There are, however, cases that require special tools and methods. Specific to these cases, Kyocera Precision Tools introduces an upgrade to the 1730 design with surface milling and plunging capabilities.

In addition, these tools generally eliminate the requirement of entry material that is sometimes needed on this type of work when using conventional cutters.

** This product requires specific processes and operating parameters.*

For optimal results, please contact a Kyocera Precision Tools field engineer.

Material: PTFE

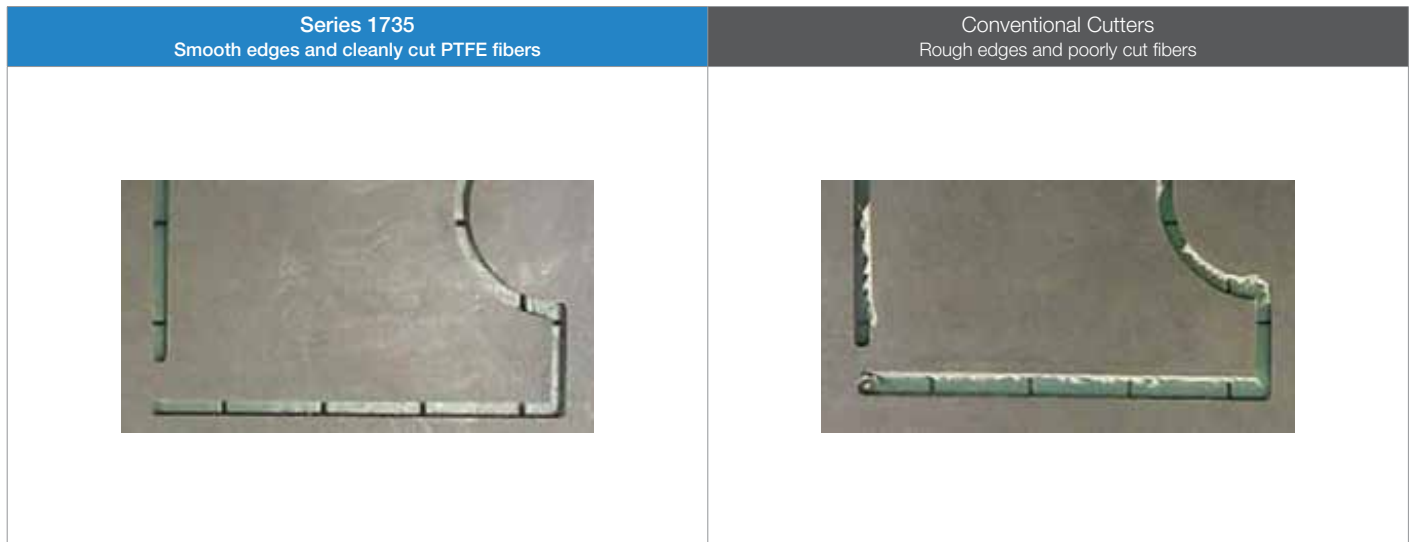

Material: Gold Tabs/Connectors



Three Flute

Square Flexible Laminates End Mills

Diameter Range
0.1250"
0.80mm ~ 2.40mm

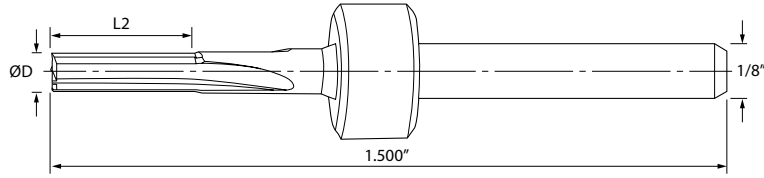

STANDARD Flute Length (Inch)



Part Number	Stock	End Mill Size	Dimensions (in)		Helix Angle
			Cutting Diameter	Flute Length	
			ØD	L2	
1735.1250.500	●	0.1250"	0.1250	0.5000	0°

STANDARD Flute Length (Metric)



Part Number	Stock	End Mill Size	Dimensions (mm)		Helix Angle
			Cutting Diameter	Flute Length	
			ØD	L2	
1735.0315.138	●	0.80mm	0.800	3.50	0°
1735.0630.315	●	1.60mm	1.600	8.00	0°
1735.0945.315	●	2.40mm	2.400	8.00	0°



Three flute zero helix end mill designed for side routing or milling printed circuit boards, gold tab connectors, soft materials, or soft metals.

 Part Numbers above include rings set at 0.800" - For Ringless Part Number, replace series "." with "-" (XXX-XXXX.XXXX) Additional diameters and special ring colors available upon request.

 For recommended cutting conditions please visit: www.kyoceraprecisiontools.com/pcb/speeds-feeds



KYOCERA Precision Tools

3565 Cadillac Ave.
Costa Mesa, CA 92626
Customer Service | 888.848.9266
Technical Support | 800.823.7284



Official Website | www.kyoceraprecisiontools.com
Distributor Website | mykpti.kyocera.com
Email | pcb.cs@kyocerapcb.com